

Gulf State Park

Enhancement Project Update

March 2017

ALABAMA'S
GULF
STATE PARK



Gulf State Park will be an international benchmark for environmental and economic sustainability demonstrating best practices for outdoor recreation, education, and hospitable accommodations.

CONTENTS

- 01 Project Overview**
Master Plan Elements
 - 02 Dune Restoration**
 - 03 Pedestrian Bridges**
 - 04 Interpretive Center**
 - 06 Learning Campus**
 - 07 The Lodge**
 - 10 Trail Enhancements**
- 

PROJECT OVERVIEW:

Master Plan

A Comprehensive Approach



Master Plan elements developed as a result of 2,600 online survey respondents, 12 stakeholder meetings, and 6 community open houses.

PROJECT OVERVIEW:

Dune Restoration

An Innovative Return to Natural Systems

Goal: Restore natural systems so the dunes can regrow themselves over time.

- The Project Team supported Park Staff efforts to place recycled Christmas trees in areas behind the engineered berm to facilitate dune growth.
- On January 20, 2017, Park staff and volunteers from area high schools and the campground community placed over 200 donated trees in the dune restoration area.
- Over time, sand will accumulate around the trees, creating a healthy dune system and habitat for the Alabama Beach Mouse, nesting sea turtles, and shore birds.



Christmas trees behind engineered berm



Volunteers placing recycled Christmas trees in dune restoration area

PROJECT OVERVIEW:
Pedestrian Bridges
 Completing the Pedestrian Network

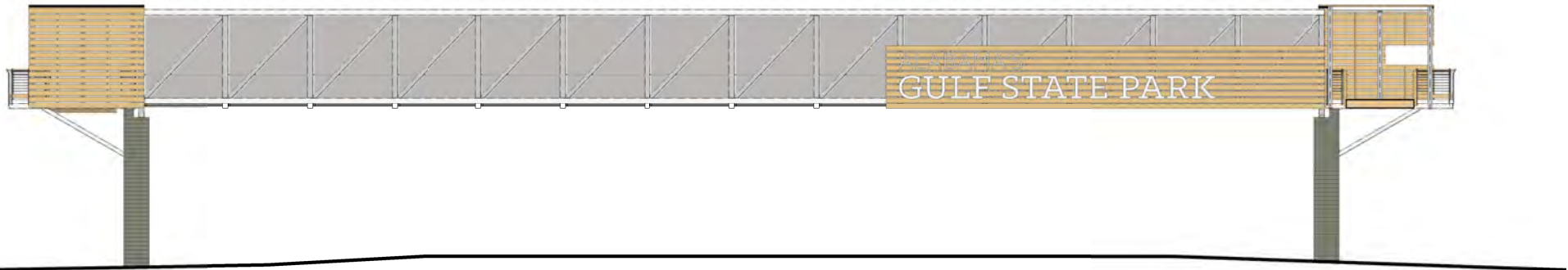

Bridge Elevation

- Two Pedestrian Bridges will increase public access to the park by providing safe pedestrian passage across East Beach Boulevard
- Both bridges complete an interpretive connection between all ecosystems of Gulf State Park
- Construction begins on Pier Bridge: Summer 2017

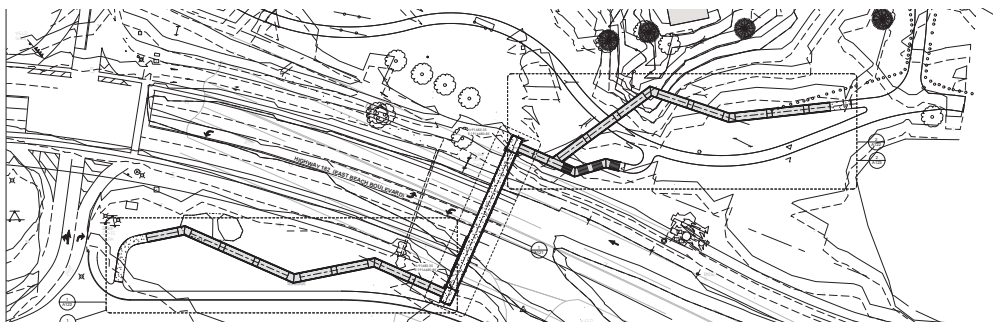

West Bridge location connecting Education Pier to Picnic Area and Trail Network

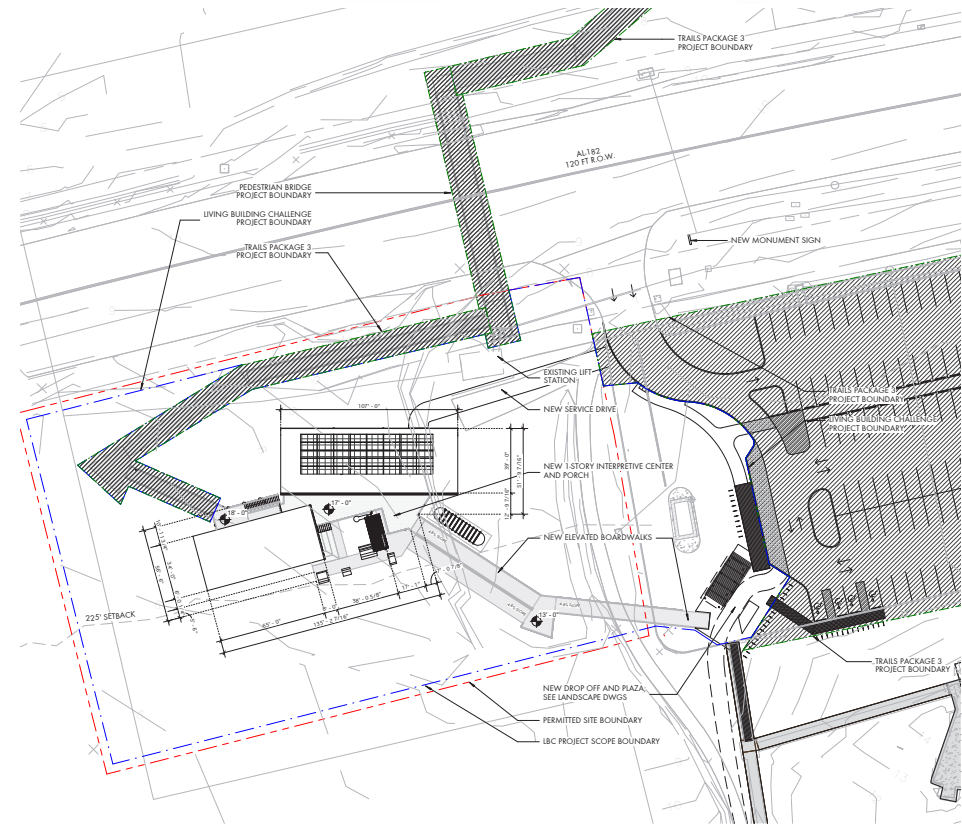

East Bridge location connecting Interpretive Center to Trail Network

PROJECT OVERVIEW:

Interpretive Center

The Launching Point into the Park

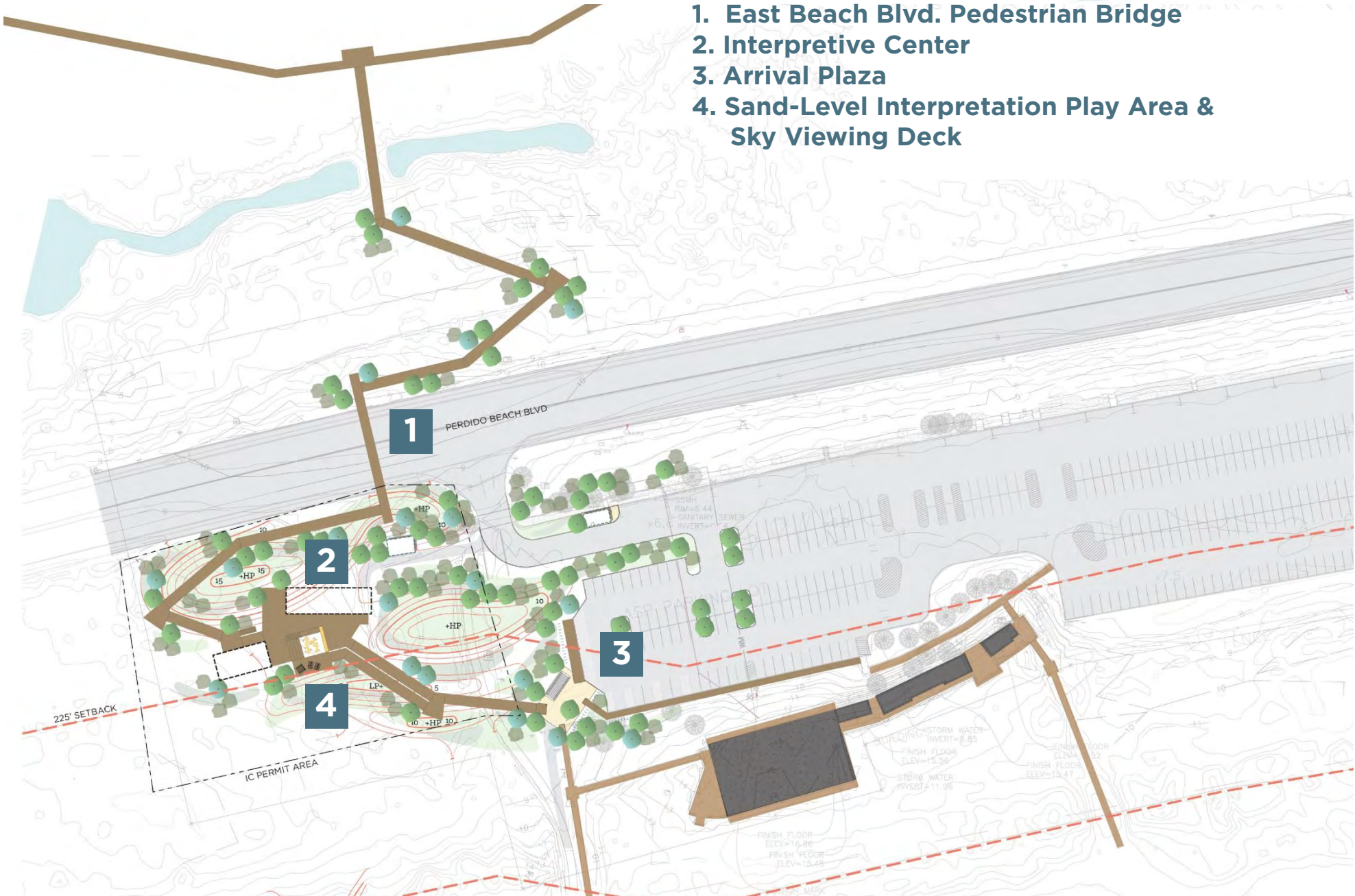

- 1. East Beach Blvd. Pedestrian Bridge
- 2. Interpretive Center
- 3. Arrival Plaza
- 4. Sand-Level Interpretation Play Area & Sky Viewing Deck

Site Plan



Sand level interactive educational elements

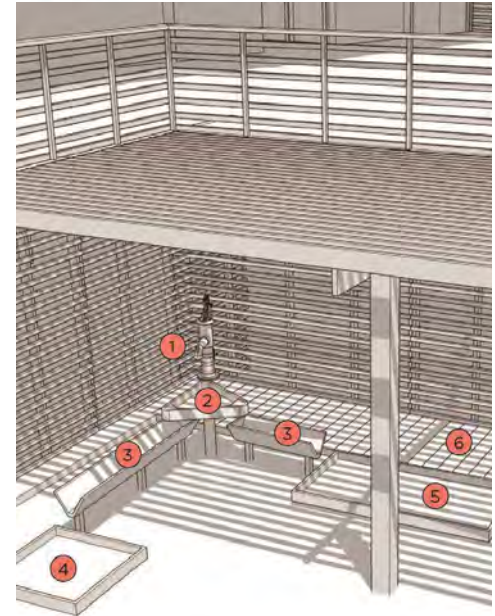

Water education and play area



Site Protection in place



Water education and play area equipment

PROJECT OVERVIEW:

Learning Campus

The Gateway to Learning



Tree Protection has been erected



Classroom Buildings



Screened Gathering Area



Natural Play Area Concept

PROJECT OVERVIEW:
Rebuilding the Lodge
A Beautiful Place



- 1. Lobby
- 2. Restaurant
- 3. Guest Rooms
- 4. Meeting Space
- 5. Ballroom
- 6. Dune Restoration
- 7. Restored Wetland

Site Plan



Park view from top floor guest room



Beach view from top floor guest room



Lodge Construction Progress - Feb 23, 2017



Beach Views



Lobby Interior Rendering



Family Friendly



Restaurant Interior Rendering



Children biking on Gopher Tortoise Trail



Eagle Loop



Beach Mouse Bypass Construction



Campground Trail